

Installation

1. Take off the 4 screws, then remove the metal support bracket from the unit. As shown in the first illustration.

2. Tighten the metal support bracket to the ceiling of vehicle as shown in the second illustration, and leave a certain space to let the connecting wire pass through. (Take extra care to unbroken the ceiling of vehicle).

3. To install the unit to the metal support bracket, connecting with the unit and the wires passing through the remain space.

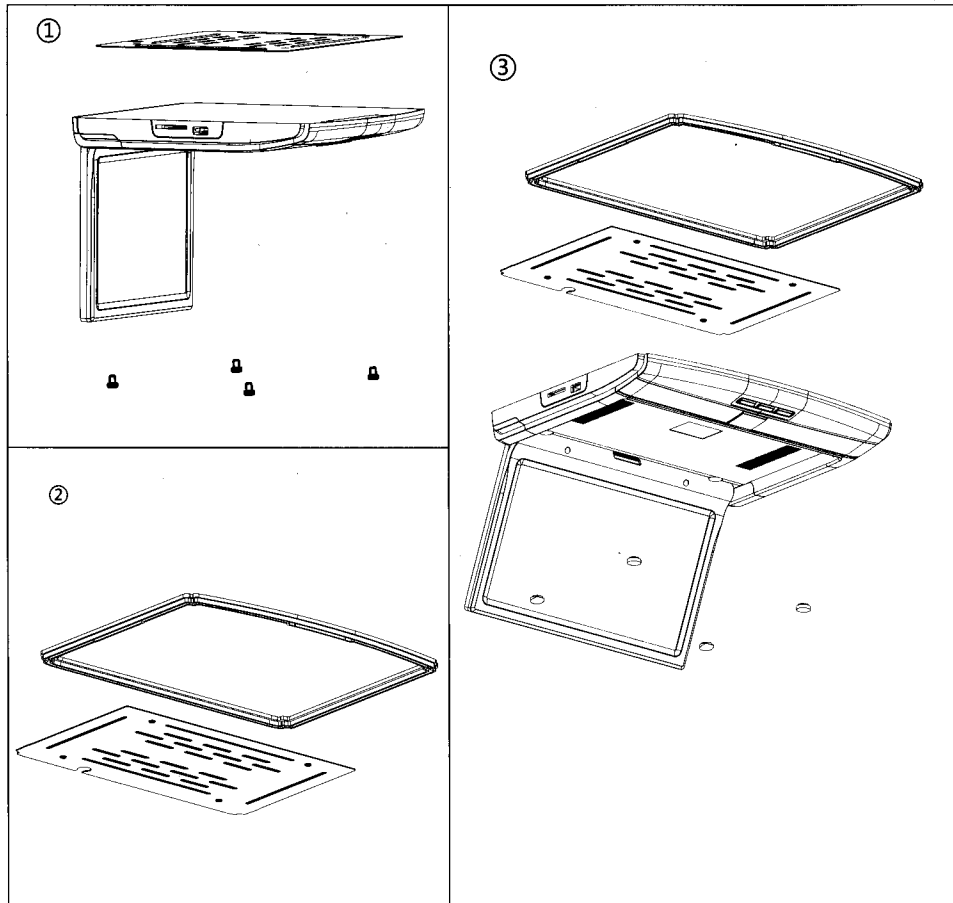

10.1&9inch ROOF MOUNT MONITOR

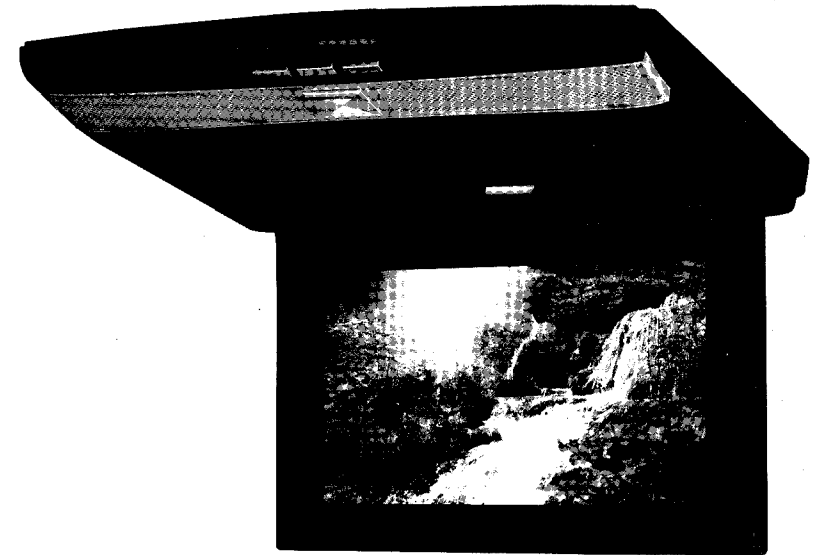

**OPERATING
INSTRUCTIONS**

Appearance and function

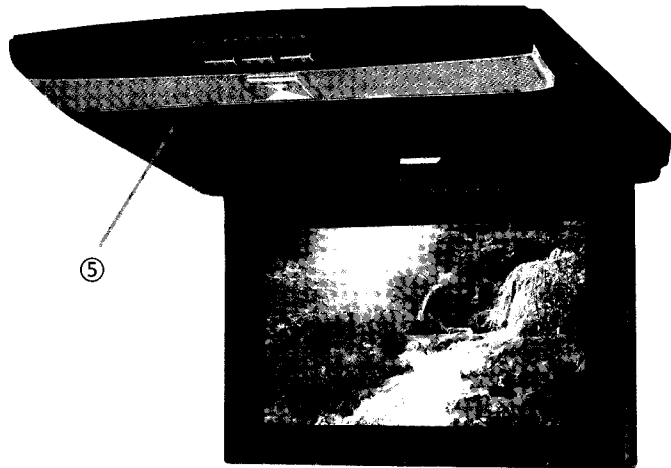
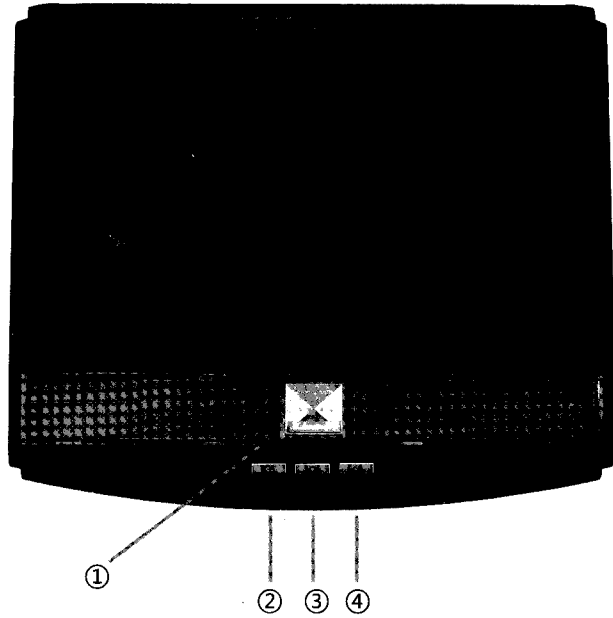

- ①. Open
- ②. AV1/AV2 Switch
- ③. light switch
- ④. Power switch
- ⑤. Standby key(optional)

Remote control panel

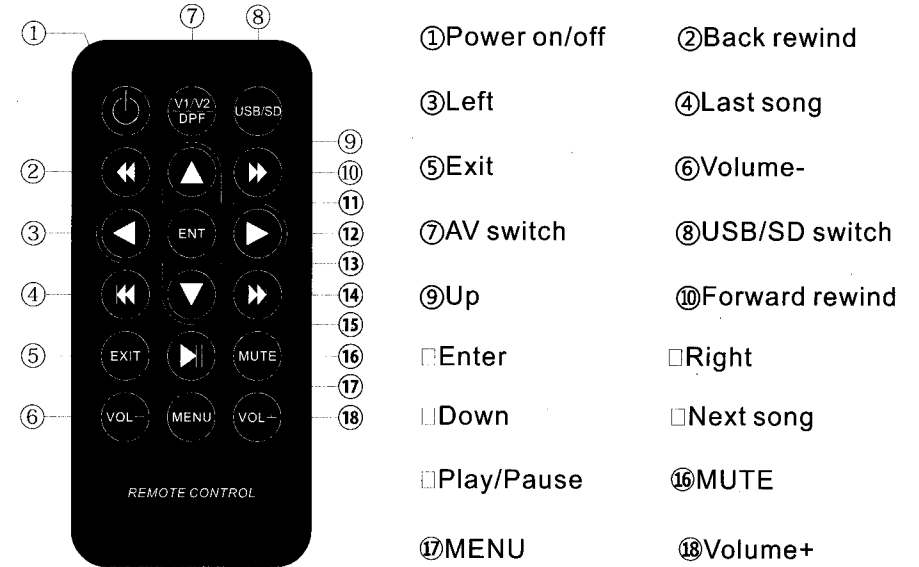

Specifications

10.1"&9"Flip Down Monitor

Resolution:

10.1inch:1024×3 (RGB) ×600

9inch:800×3 (RGB) ×480

Built-in IR Transmitter(optional)

Built-TV Tuner(optional)

2Video inputs

Built in Dual Dome Lights

Wireless Remote Control

Power Supply:DC 12V

Wiring Diagram

