

LATCHING RELAY

The 5087 is basically a solenoid operated SPDT switch. The switch will change position each time the solenoid is activated.

By connecting one terminal of the solenoid to 12vdc+ and sending a momentary ground to the other terminal, the solenoid will activate and mechanically operate the switch, first closing one set of contacts and then the other. The contacts are rated at 15A.

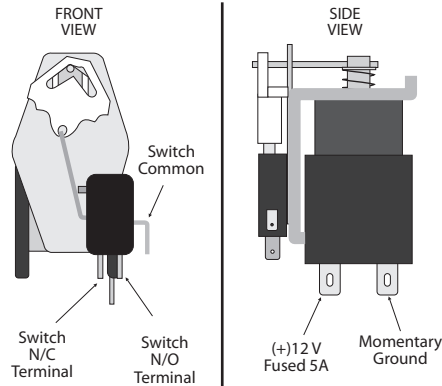

ACCELE ELECTRONICS, INC.

Rev. 7-99

LATCHING RELAY

The 5087 is basically a solenoid operated SPDT switch. The switch will change position each time the solenoid is activated.

By connecting one terminal of the solenoid to 12vdc+ and sending a momentary ground to the other terminal, the solenoid will activate and mechanically operate the switch, first closing one set of contacts and then the other. The contacts are rated at 15A.

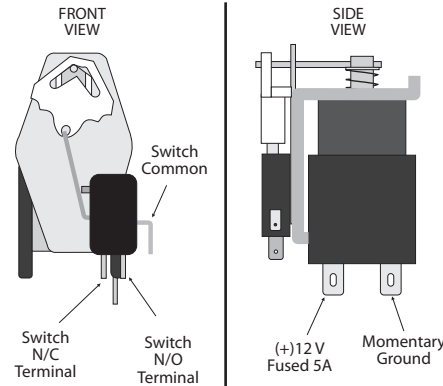

ACCELE ELECTRONICS, INC.

Rev. 7-99

LATCHING RELAY

The 5087 is basically a solenoid operated SPDT switch. The switch will change position each time the solenoid is activated.

By connecting one terminal of the solenoid to 12vdc+ and sending a momentary ground to the other terminal, the solenoid will activate and mechanically operate the switch, first closing one set of contacts and then the other. The contacts are rated at 15A.

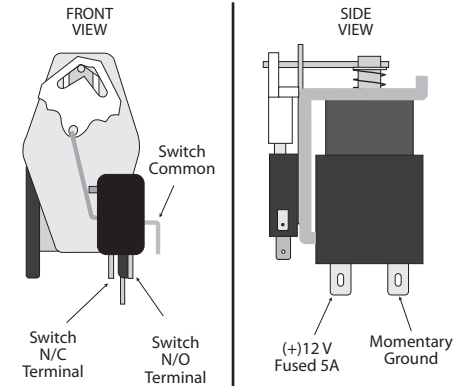

ACCELE ELECTRONICS, INC.

Rev. 7-99

LATCHING RELAY

The 5087 is basically a solenoid operated SPDT switch. The switch will change position each time the solenoid is activated.

By connecting one terminal of the solenoid to 12vdc+ and sending a momentary ground to the other terminal, the solenoid will activate and mechanically operate the switch, first closing one set of contacts and then the other. The contacts are rated at 15A.

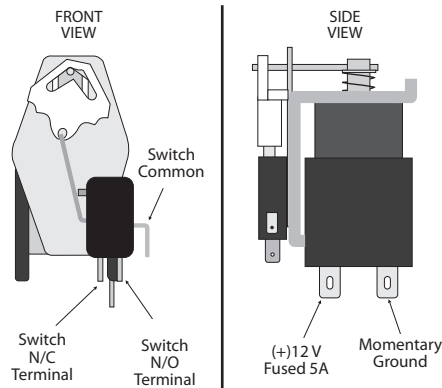

ACCELE ELECTRONICS, INC.

Rev. 7-99

LATCHING RELAY

The 5087 is basically a solenoid operated SPDT switch. The switch will change position each time the solenoid is activated.

By connecting one terminal of the solenoid to 12vdc+ and sending a momentary ground to the other terminal, the solenoid will activate and mechanically operate the switch, first closing one set of contacts and then the other. The contacts are rated at 15A.

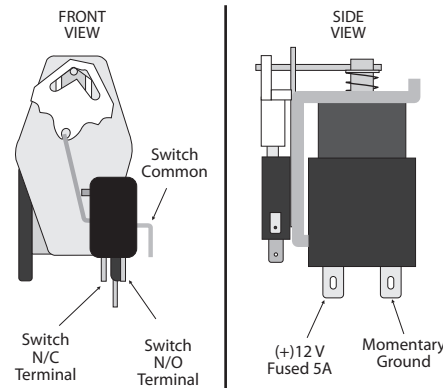

ACCELE ELECTRONICS, INC.

Rev. 7-99

LATCHING RELAY

The 5087 is basically a solenoid operated SPDT switch. The switch will change position each time the solenoid is activated.

By connecting one terminal of the solenoid to 12vdc+ and sending a momentary ground to the other terminal, the solenoid will activate and mechanically operate the switch, first closing one set of contacts and then the other. The contacts are rated at 15A.

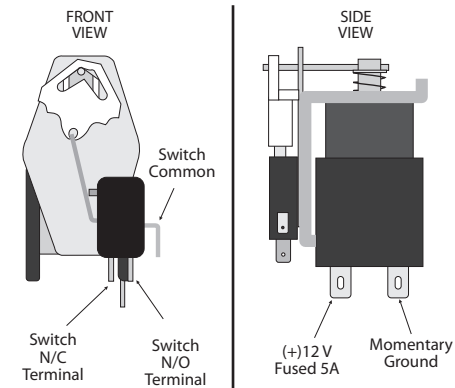

ACCELE ELECTRONICS, INC.

Rev. 7-99